



American
Jewish
University

American Jewish University, Familian Campus 2021 Campus Security and Fire Safety Report

The 1990 Jeanne Clery Disclosure of Campus Security Policy and Campus Crime Statistics Act, known as the Clery Act, requires all institutions of higher education that participate in federal aid programs to distribute this annual report. General questions may be direct to the Office of Student Affairs (studentaffairs@aju.edu).

DISSEMINATION OF SECURITY INFORMATION

Security information is made available to the campus community via the publication of this report. Employees also receive security information during regular staff meetings and may be asked to attend extraordinary informational meetings and training sessions. Students also receive security information during orientation sessions and via the Student Handbook. Non-student campus residents also receive security information from facilities administrators.

REPORTING EMERGENCIES, CRIMINALITY, OR SECURITY ISSUES

In the event of an emergency, including medical emergencies requiring immediate attention, students, faculty, and staff should first call 911 and then campus security (310-440-1590 / 310-948-2065 / aju.security@aju.edu). Non-emergency criminal actions and security issues should be reported to campus security, which will report them to appropriate law enforcement agencies (normally the West LA Community Police Station). Missing students should be reported to campus security, the Office of Student Affairs, and appropriate law enforcement agencies.

SECURITY AND CAMPUS LAW ENFORCEMENT

AJU expects members of the campus community to abide by applicable laws both on and off campus. Students, faculty, and staff are encouraged to report crimes promptly. Campus security guards monitor entry to the campus, enforce parking regulations, and otherwise secure the campus. Campus security will report violations of local, state, or federal laws to appropriate authorities. Security personnel on campus have the authority to detain individuals while criminal actions are being reported to appropriate authorities. The Office of Student Affairs, in conjunction with Campus Security, enforces residential policies, which can be found in the Student Handbook.

EMERGENCY RESPONSE AND EVACUATION PROCEDURES

The evacuation of campus buildings or the entire American Jewish University Campus may be required due to the emergency situations occurring on or near the campus. Whenever possible the evacuation will be done in a systematic, controlled and planned manner.

To facilitate the safe evacuation of campus buildings and to help inform emergency responders of urgent needs, the campus utilizes an Emergency Response Plan. This program is staffed by specially trained volunteers (the Emergency Response Team / ERT) who work in individual classrooms and offices within buildings on the campus. When an evacuation is ordered, the ERT are responsible for:

- assisting in the safe and complete evacuation of a building.
- preventing non-emergency responders from re-entering an evacuated building.
- reporting injured or trapped persons to emergency responders.

In order to facilitate the safe and orderly evacuation of the campus, a Staging Area System may be employed to control the release of people. This system would normally be used following a major disaster where the buildings have been deemed uninhabitable and a full campus evacuation has been ordered. American Jewish University maintains two Primary Staging Areas and two Secondary Staging Areas:

- Primary Staging Areas: Parking Lot 1 and Parking Lot 4
- Secondary Staging Areas: Sculpture Garden and Grass Area

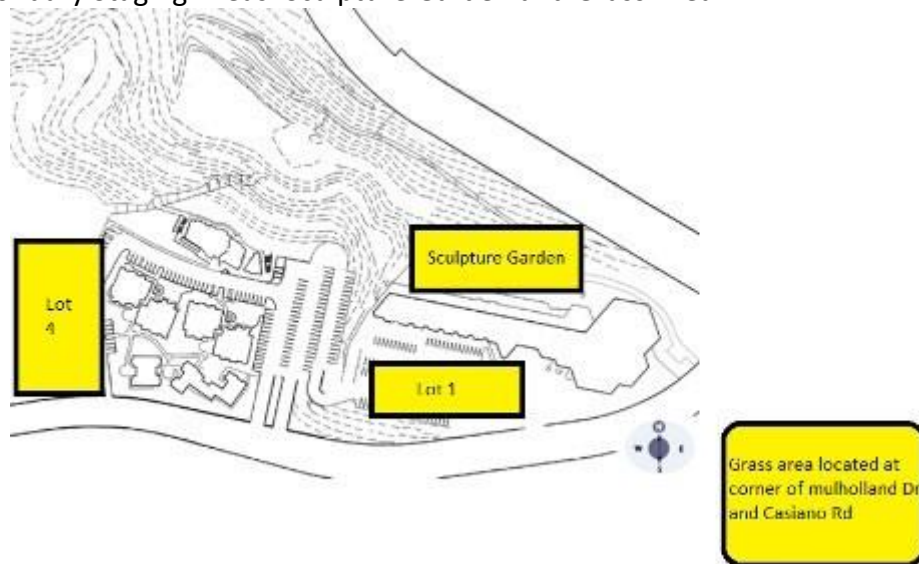

Under the Staging Area System, people evacuated from their buildings are moved to one of the staging areas and held there until roadways are deemed safe and open or it is decided they must be sheltered on campus.

Additional emergency procedures relevant to earthquakes are detailed in the Student Handbook.

ALCOHOL AND DRUG POLICY

AJU complies with the U.S. Department of Education zero tolerance policy for alcohol and drug use/abuse as stipulated in the Higher Education Act. The unlawful possession, manufacture, distribution, use, sale, or gift of alcohol or illicit drugs is prohibited in and on AJU property, or as part of any AJU activity. This includes being under the influence of alcohol and/or any illicit drugs. Students under the age of 21 are not permitted to consume alcohol. In accordance with residence life policies, alcohol may be stored in a residence hall room if all persons residing in that room are over the age of 21, and may be consumed only when everyone present is over the age of 21. Students are expected to comply with all federal, state and local laws. Marijuana is illegal according to federal law, regardless of medical recommendations or state law. The use, possession, manufacture, or sale of illicit drugs, the misuse of prescription drugs or other legal substances, and the possession of drug paraphernalia is prohibited on campus. Any student who violates this policy is subject to disciplinary action up to and including expulsion from the University, referral for prosecution and/or referral to an appropriate evaluation or rehabilitation program. AJU is obligated to report the illegal sale and/or distribution of drugs to legal authorities.

SEXUAL CRIMES AND MISCONDUCT

AJU prohibits all forms of sexual and/or gender harassment or misconduct, and encourages reporting of sexual misconduct. Sexual misconduct may be reported at any time, regardless of how much time has elapsed since the incident occurred. Any applicant for admission or employment, along with any member of the AJU community has the right to raise concerns or make a complaint regarding discrimination, harassment or other forms of sexual misconduct without fear of retaliation. Any such concerns or complaints will be promptly investigated, and appropriate action will be taken. Members of the AJU community who believe they have experienced sexual misconduct have the right to choose whether to engage with the University once the University receives a report. The University prohibits retaliation against those who file a complaint or third-party report, or otherwise participate in the investigative and/or complaint resolution process (e.g., as a witness).

AJU strongly encourages persons who experience sexual misconduct which may constitute a violation of law (rape, sexual assault, relationship violence, etc.) to report the incident to local law enforcement at any time, 24 hours a day, 7 days a week, by calling 911. Filing a police report can result in the investigation of criminal behavior and the prosecution of the perpetrator. Timely reporting to the police is an important factor in successful investigation and prosecution of crimes, including sexual violence. At an individual's request, the University will assist the individual in contacting law enforcement. If the individual decides to pursue a criminal complaint, the University will cooperate with law enforcement agencies to the extent permitted by law. An individual has the option to decide whether or not to participate in any investigation conducted by law enforcement.

A criminal investigation into an allegation of sexual misconduct does not relieve or substitute for the University's duty and authority to conduct its own prompt review of a complaint. Accordingly, the University will not wait for the conclusion of a criminal

investigation or proceeding to begin its own concurrent investigation and resolution of an alleged violation. The standards for criminal proceedings differ from those used in campus proceedings. As a result, conduct that may not be subject to criminal action may still be addressed through University processes and procedures. A finding of “not guilty” in a criminal matter does not necessarily preclude a finding of responsibility for violating this policy in a University proceeding.

The University encourages reporting of sexual misconduct and seeks to remove any barriers to making a report. The University recognizes that an individual who has been consuming alcohol (including underage consumption) or using drugs at the time of the incident may be hesitant to make a report because of potential consequences for that conduct. To encourage reporting, an individual who makes a good faith report of sexual misconduct that was directed at them or another person or participates in an investigation as a witness will not be subject to disciplinary action by the University for a conduct or policy violation that is related to and revealed in the sexual misconduct report or investigation, unless the University determines that the violation was serious and/or placed the health or safety of others at risk.

Title IX of the Education Amendments of 1972 (Title IX) prohibits discrimination based on sex in education programs and activities receiving federal financial assistance. Under Title IX, discrimination on the basis of sex can include sexual misconduct, such as sexual harassment, unwelcomed sexual advances, or sexual violence (e.g., sexual assault, sexual battery, sexual coercion, and rape).

AJU’s policies regarding Title IX are available [online](#) and from the Office of Student Affairs. All AJU community members including students, faculty, staff, volunteers, visitors, and any individuals regularly or temporarily employed, studying, living, visiting, conducting business, or having any official capacity with AJU or on AJU property, are expected and required to comply with AJU’s Title IX policy.

AJU’s Title IX Coordinator is responsible for coordinating the University’s compliance with Title IX, which includes providing education and training; tracking and reporting annually on all incidents in violation of this policy; and investigating, responding to, and resolving all reports under this policy. The Title IX Coordinator is knowledgeable about, and will provide information on, options for addressing and resolving complaints about discrimination on the basis of sex and gender (including sexual misconduct).

Reports addressing potential violations of Title IX may be filed by emailing TITLEIX@aju.edu, or by visiting or calling AJU’s Title IX coordinator. Current contact information for the Title IX coordinator may be found [online](#) or obtained from the Office of Student Affairs. Title IX reports and complaints may be submitted anonymously. Anonymity may limit the University’s ability to investigate and otherwise address the content of reports and complaints.

The Campus Sex Crimes Prevention Act requires the University to advise the campus community that information provided by the State of California concerning registered sex

offenders may be obtained on-line at www.meganslaw.ca.gov or by contacting the Los Angeles Police Department.

CAMPUS CRIME STATISTICS

The tables below provide statistical information for certain categories of criminal activity on AJU’s Familian Campus reported to AJU campus security or the Los Angeles police Department during the previous three years.

Criminal Offenses – Campus			
Category	2018	2019	2020
Murder / Non-negligent Manslaughter	0	0	0
Manslaughter by Negligence	0	0	0
Rape	0	0	0
Fondling	0	0	0
Incest	0	0	0
Statutory Rape	0	0	0
Robbery	0	0	0
Aggravated Assault	0	0	0
Burglary	0	0	0
Motor Vehicle Theft	0	0	0
Arson	0	0	0

Criminal Offenses – On-campus Student Housing Facilities			
Category	2018	2019	2020
Murder / Non-negligent Manslaughter	0	0	0
Manslaughter by Negligence	0	0	0
Rape	0	0	0
Fondling	0	0	0
Incest	0	0	0
Statutory Rape	0	0	0
Robbery	0	0	0
Aggravated Assault	0	0	0
Burglary	0	0	0
Motor Vehicle Theft	0	0	0
Arson	0	0	0

Criminal Offenses – Public Property			
Category	2018	2019	2020
Murder / Non-negligent Manslaughter	0	0	0
Manslaughter by Negligence	0	0	0
Rape	0	0	0
Fondling	0	0	0
Incest	0	0	0

Statutory Rape	0	0	0
Robbery	0	0	0
Aggravated Assault	0	0	0
Burglary	0	0	0
Motor Vehicle Theft	0	0	0
Arson	0	0	0

Hate Crimes – Campus						
Category	2018	bias	2019	bias	2020	Bias
Murder / Non-negligent Manslaughter	0	--	0	--	0	--
Manslaughter by Negligence	0	--	0	--	0	--
Rape	0	--	0	--	0	--
Fondling	0	--	0	--	0	--
Incest	0	--	0	--	0	--
Statutory Rape	0	--	0	--	0	--
Robbery	0	--	0	--	0	--
Aggravated Assault	0	--	0	--	0	--
Burglary	0	--	0	--	0	--
Motor Vehicle Theft	0	--	0	--	0	--
Arson	0	--	0	--	0	--
Simple Assault	0	--	0	--	0	--
Larceny - Theft	0	--	0	--	0	--
Intimidation	0	--	0	--	0	--
Property Destruction / Damage / Vandalism	0	--	1	Religion	0	--

Hate Crimes – On-campus Student Housing Facilities						
Category	2018	bias	2019	bias	2020	Bias
Murder / Non-negligent Manslaughter	0	--	0	--	0	--
Manslaughter by Negligence	0	--	0	--	0	--
Rape	0	--	0	--	0	--
Fondling	0	--	0	--	0	--
Incest	0	--	0	--	0	--
Statutory Rape	0	--	0	--	0	--
Robbery	0	--	0	--	0	--
Aggravated Assault	0	--	0	--	0	--
Burglary	0	--	0	--	0	--
Motor Vehicle Theft	0	--	0	--	0	--
Arson	0	--	0	--	0	--
Simple Assault	0	--	0	--	0	--
Larceny - Theft	0	--	0	--	0	--
Intimidation	0	--	0	--	0	--
Property Destruction / Damage / Vandalism	0	--	0	--	0	--

Hate Crimes – Public Property						
Category	2018	bias	2019	bias	2020	Bias
Murder / Non-negligent Manslaughter	0	--	0	--	0	--
Manslaughter by Negligence	0	--	0	--	0	--
Rape	0	--	0	--	0	--
Fondling	0	--	0	--	0	--
Incest	0	--	0	--	0	--
Statutory Rape	0	--	0	--	0	--
Robbery	0	--	0	--	0	--
Aggravated Assault	0	--	0	--	0	--
Burglary	0	--	0	--	0	--
Motor Vehicle Theft	0	--	0	--	0	--
Arson	0	--	0	--	0	--
Simple Assault	0	--	0	--	0	--
Larceny - Theft	0	--	0	--	0	--
Intimidation	0	--	0	--	0	--
Property Destruction / Damage / Vandalism	0	--	0	--	0	--

Violence Against Women Act (VAWA) Offenses – Campus			
Category	2018	2019	2020
Domestic Violence	0	0	0
Dating Violence	0	0	0
Stalking	0	0	0

Violence Against Women Act (VAWA) Offenses – On-campus Student Housing Facilities			
Category	2018	2019	2020
Domestic Violence	0	0	0
Dating Violence	0	0	0
Stalking	0	0	0

Violence Against Women Act (VAWA) Offenses – Public Property			
Category	2018	2019	2020
Domestic Violence	0	0	0
Dating Violence	0	0	0
Stalking	0	0	0

No crime reports were unfounded and subsequently withheld from crime statistics for the years covered in the above tables.

FIRE SAFETY SYSTEMS

Fire and Life Safety (FLS) systems are maintained by an outside vendor. All systems are inspected quarterly, upgraded as needed, and otherwise maintained in compliance with relevant ordinances.

FIRE SAFETY EDUCATION AND TRAINING

Training for the FLS system is provided by the vendor. Building fire drills are conducted at least once per year.

CAMPUS FIRE SAFETY POLICIES

In order to ensure the proper function of fire and safety equipment, and in accordance with California Penal Code §148.4, the following acts are prohibited:

- willfully or maliciously tampering with, molesting, injuring, or breaking any fire protection equipment, fire protection installation, fire alarm apparatus, wire, or signal
- willfully or maliciously sending, giving, transmitting, or sounding any false alarm of fire, by means of any fire alarm system or signal or by any other means or methods
- removing smoke detector or carbon monoxide detector batteries or otherwise rendering such devices inoperative

In order to ensure rapid evacuation in the case of an emergency, furniture, debris, or any other materials must not block doorways, halls, stairwells, and other avenues of egress.

STUDENT HOUSING FIRE SAFETY POLICIES

Fire safety policies for student housing facilities are detailed in the Student Handbook.

Electrical appliances are permitted in residence halls within certain guidelines. Appliances must be safe in design and structure (e.g., UL-approved appliances), and be properly maintained. In general, appliances with exposed heating elements (e.g., hot plates, toasters, skillets) are not permitted in residence halls; exceptions include hair dryers, curling irons and clothes irons.

Candles, incense, sage, plug-in scented devices, and similar items are not permitted in residence halls. Such items may be used for religious purposes only in designated common areas with prior authorization.

Firecrackers, fireworks, explosives, flammable chemicals/materials, or pyrotechnics of any nature are not permitted within or around residence halls.

STUDENT HOUSING FIRE STATISTICS

Student Housing Fire Statistics						
residence hall	year	# of fires	injuries	deaths	property damage	cause
Lee Hall	2018	0	0	0	0	0
	2019	0	0	0	0	0
	2020	0	0	0	0	0
Keefer Hall	2018	0	0	0	0	0
	2019	0	0	0	0	0
	2020	0	0	0	0	0
Rochlin Hall	2018	0	0	0	0	0
	2019	0	0	0	0	0
	2020	0	0	0	0	0
Taper Hall	2018	0	0	0	0	0
	2019	0	0	0	0	0
	2020	0	0	0	0	0
Sol & Anne Dorff Residence	2018	0	0	0	0	0
	2019	0	0	0	0	0
	2020	0	0	0	0	0
Max & Gertrude Nelson Residence	2018	0	0	0	0	0
	2019	0	0	0	0	0
	2020	0	0	0	0	0

